

› INTRASTACK SHORT WALL SOLUTION

SFS/INFILL – PONY WALL

Low level wall solution.
Wall heights up to 1.2m.

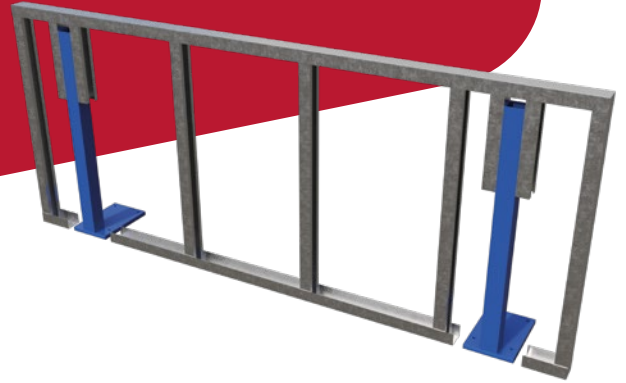

What is a short wall?

A short wall (or pony wall) is a partial-height wall that does not extend all the way to the ceiling. Instead, it typically rises to about halfway up the room. Our short wall solution has a maximum wall height of 1.2m, but can be lower if required.

Short walls are constructed using the same framing and finishing methods as standard full-height walls, making them a practical and versatile feature for dividing spaces while maintaining an open feel.

Where are they used?

Short walls can be found in many spaces in the home or commercial spaces to create separate areas or provide privacy while maintaining an open feel. These pony walls can mark subtle changes between floor levels, and along stairways they serve as a safety barrier on upper floors while keeping the space visually open.

Intrastack SFS Solution

Intrastack's SFS/infill system can include pony walls as part of the offer. Ensure you include your low height wall requirements when sending over your designs, so that our team can ensure your project goes without a hitch.

Building Regulations and Compliance

Intrastack's SFS short wall solution adheres to UK building regulations, and the wall sections carry both the CE and UKCA marks.

BS 6180-2011

**The low wall system satisfies
BS 6180-2011
(barriers in and about buildings).**

**BS 6180
(barriers in and about buildings):**

- › gives guidance on building temporary and permanent barriers around buildings to protect people.
- › details the latest recommendations and guidance for the construction of barriers in and around buildings.
- › provides a comprehensive guide to the design, structure, height, and strength of barriers. This includes recommendations on all materials used such as aluminium and copper alloys, concrete, plastic, steel, stone, and wood.

BS 6180 applies to temporary and permanent barriers designed to protect people from hazards, restrict access, or control vehicle traffic. It outlines requirements for protective, crash and crush barriers as well as those that impose a speed limit of up to 16km/h (4.44m/s or 10miles/h).

**BS 6180: 2011
(barriers in and about buildings)** is a full revision of the 1999 edition.

See the British Standards Institution for more details on BS 6180:2011 (barriers in and about buildings).

intrastack

SAINT-GOBAIN

> SPECIFICATIONS

SK01

CENTERED POST



OFFSET POST

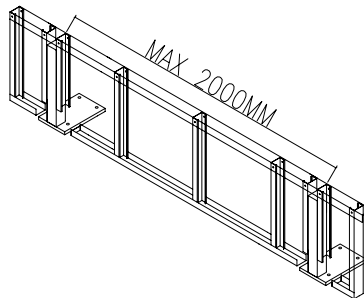
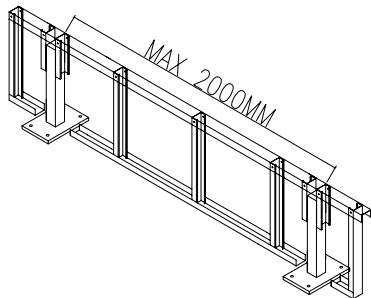

LOW LEVEL WALL

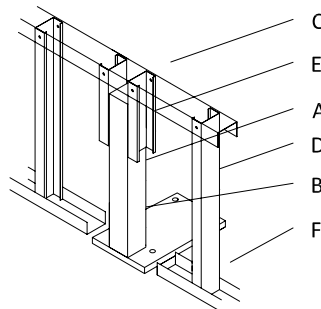
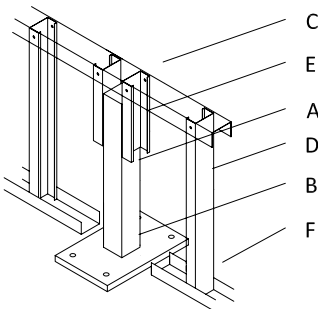

POST DIMENSIONS

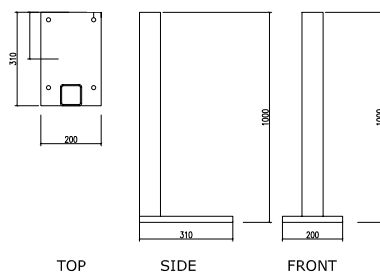
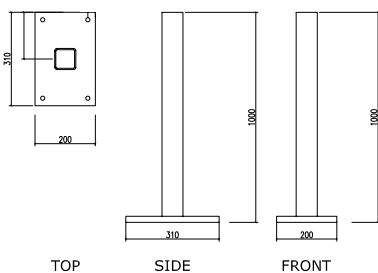

SPECIFICATION

Maximum wall height 1.2m

Maximum post spacing 2.0m

COMPONENTS

- A.** Post - 70x70x5.0 SHS
- B.** Base Plate - 200x300x20
- C.** Top Track - U.74.70.20
- D.** Studs - C.70.50.12 @ 600ctrs
- E.** Connected Stud - C.70.50.12, 400mm length
- F.** Base Track - U.74.50.12

FIXINGS

- > Post to Slab - 4no M12 LDT (Large Diameter Tapcon) Or equivalent
- > Stud to Track - 1no 5.5mm diameter tec screw each side
- > Connection Stud to Post - 4no HD fine thread tec screw

NOTE

- > This solution is only suitable when fixing to top of the concrete slab. E.g. Should not be fixed to a screed or raised access floor system.
- > Interface with abutting walls is aesthetic only and provides no structural or other performance.
- > Finish with appropriate materials such as Gyproc Sealant.
- > All projects will be reviewed by our experienced team of specialist steel frame engineers to ensure the correct specification is applied to your project.
- > For further guidance, contact our technical support team at intrastack@saint-gobain.com